

OL800 SOLAR LED OBSTRUCTION LIGHT

The OL800 is a self-contained solar light using high-efficiency solar panels that requires minimal ongoing maintenance. With the top-mounted LED display and simple tap-to-activate feature, you can easily check light settings without an external controller. The rugged design ensures the maximum battery life and light performance even in the harshest of environments.

Key Features

- Long-lasting batteries available in Compact and Large
- Optional charging port enables backup energy source during prolonged low-sunlight conditions
- Applications include Cranes, Barricades, Wind Turbines, Rooftops, Bridges, and Construction Sites



Intuitive Setup and Programming

Ready to use straight out of the box, the top-mounted LED display has a tap-to-activate functionality allowing users to monitor battery status and easily view/adjust light settings without an external controller.

Intelligent Energy Management

With high-efficiency solar panels and Maximum Power Point Tracking (MPPT) technology, the system optimizes energy collection and usage for maximum battery life and reliable light performance.

Durable, Low Maintenance

This maintenance-free system integrates solar panels, battery, electronics, and LED light into a single unit. The replaceable battery extends the lifespan beyond five years for lasting reliability.

Technical Specifications

LIGHT CHARACTERISTICS

LIGHT SOURCE	High-powered LED
AVAILABLE COLORS	Red, Red/IR
FLASH CHARACTERISTICS	Steady-on and Multiple Flash Patterns
LED LIFE EXPECTANCY	>100,000 Hours

SOLAR CHARACTERISTICS

PANEL DESIGN	Best-in-class High-efficiency Solar Cells with Blocking Diodes
CHARGING REGULATION	Maximum Power Point Tracking with Temperature Compensation (MPPT-TC)

POWER SUPPLY

BATTERY TYPE	Sealed Lead Acid (SLA), Replaceable and Recyclable
RED AUTONOMY*	Compact 5-7 days Large 16-19 days
RED/IR AUTONOMY*	Compact 2-5 days Large 13-15 days

PHYSICAL CHARACTERISTICS

BODY MATERIAL	Powder-coated Aluminum Chassis Polycarbonate/Polysiloxane Co-polymer Base Waterproof, Vented Battery Compartment Integrated Handle
BODY COLOR	Grey
LENS MATERIAL	UV-resistant Polycarbonate
LENS DESIGN	Multi-LED Optic
MOUNTING	3 or 4, 7.9" (200 mm) Bolt
HEIGHT	Compact 8.9 in (228 mm) Large 13.1 in (333 mm)
WIDTH	9.2 in (235 mm)
WEIGHT	Compact 11.1 lbs (5.0 kg) Large 17.7 lbs (8.0 kg)
SERVICE LIFE	Up to 12 Years

ENVIRONMENTAL STANDARDS

TEMPERATURE RANGE	Optimal -22 to 122°F (-30 to 50°C) Maximum -40 to 176°F (-40 to 80°C)
WIND	161.1 mph (72 m/s)
ICE LOADING	0.03 psi (22 kg/m ²)
SHOCK AND VIBRATION	MIL-STD-202G
INGRESS	EN 60529 IP 68 Immersion MIL-STD-202G Immersion and Damp Heat Cycling MIL-STD-810G Rain and Salt Fog
ELECTROSTATIC DISCHARGE (ESD)	FAA-STD-0193 EN61000-4-2

COMPLIANCE

FAA	FAA L-810 FAA AC 150/5345-43G
ICAO	ICAO Low Intensity Types A & B (Red)
CASA	CASA 10 cd (Part 139, Vol. 2)
PHOTOMETRICS	IES LM-80
QUALITY ASSURANCE	ISO 9001:2015
TRADEMARKS	Flash and Flash Technology® are brand of SPX Aids to Navigation (a division of SPX Technologies)

OTHER

STANDARD ACCESSORIES	Bird Deterrent Quick Start Guide
OPTIONS	Charging Port GPS or Wired Synchronization Red with Infrared (IR) LED Infrared (IR) Programmer
WARRANTY	Light 3 Years Battery 1 Year Visit flashtechnology.com for Warranty Statement and Terms and Conditions
TERMS AND CONDITIONS	Please Refer to the Product Manual for Further Information

TECHNICAL DRAWINGS

COMPACT

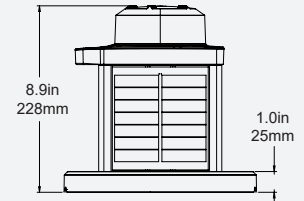

LARGE

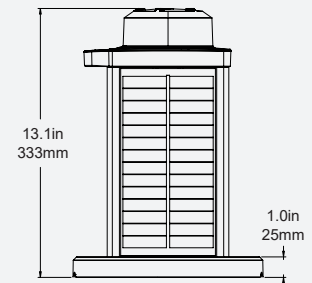

BOLT PATTERN

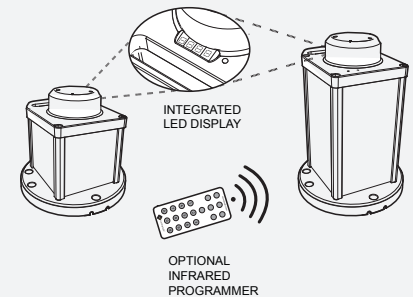
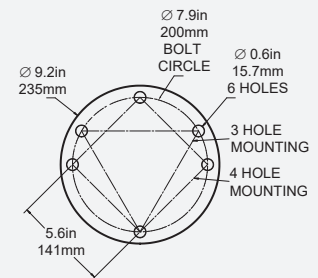

*Depending on location.